

SPA 6701 ALL DIRECTION SHOWER COMBO

- Material: 304 stainless steel and silicone hose
- Available Finishes: Polished Chrome (CH)
Matte Black (MB)
- Upper Arm is flexible for easy adjustment
- 6" Overhead Shower Head with 5 Functions
- 4.3" Handshower with 6 Functions
- Turn knob 2 way diverter

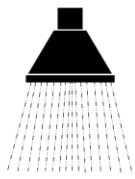

Saturating

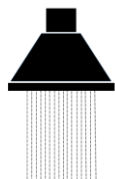

Central Superfine



Massage
Spray

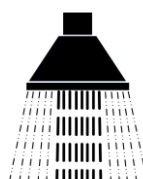

Saturating &
Massage Spray

Handshower Only

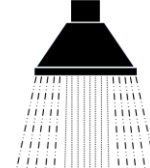

Saturating &
Superfine Spray



Trickle

LIST OF INCLUDED PARTS AND COMPONENTS:

- DIVERTER



- 6 INCH SHOWER HEAD WITH 5 FUNCTIONS



- 4.3 INCH HAND SHOWER WITH 6 FUNCTIONS



- 60 INCH SHOWER HOSE



- UPPER TUBE

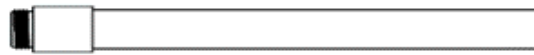

- DOWN TUBE

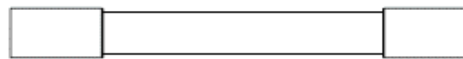

- HAND-SHOWER HOLDING BRACKET



- FLEXIBLE WASHERS



- TEFLON TAPE

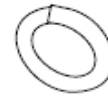

- SET SCREW AND ALLEN WRENCH



IMPORTANT INSTRUCTIONS

1. Attach the diverter onto the shower arm. Wrap the threaded end of the shower arm with the included Teflon tape to create water tight seal. Tighten with a wrench.

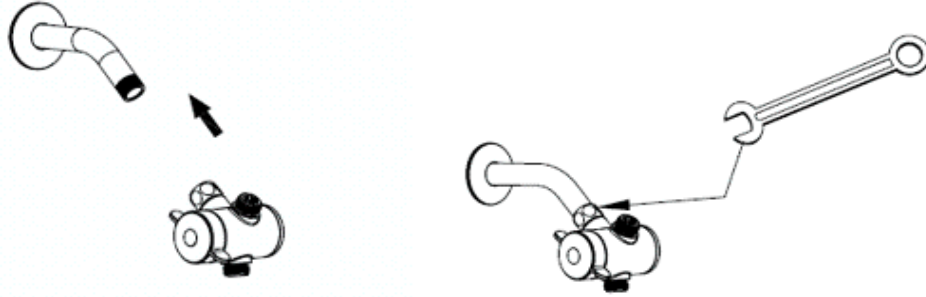

2. Attach the upper tube onto the top of the diverter.

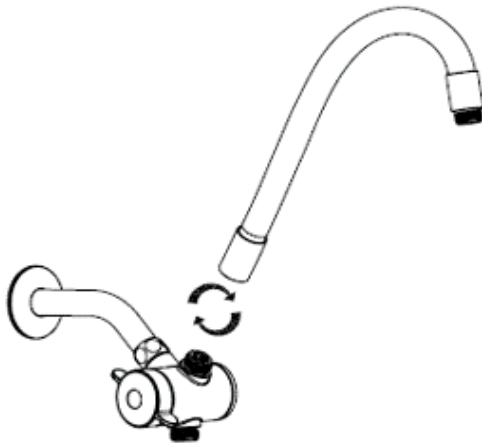

3. Attach the down tube onto the bottom of the diverter.

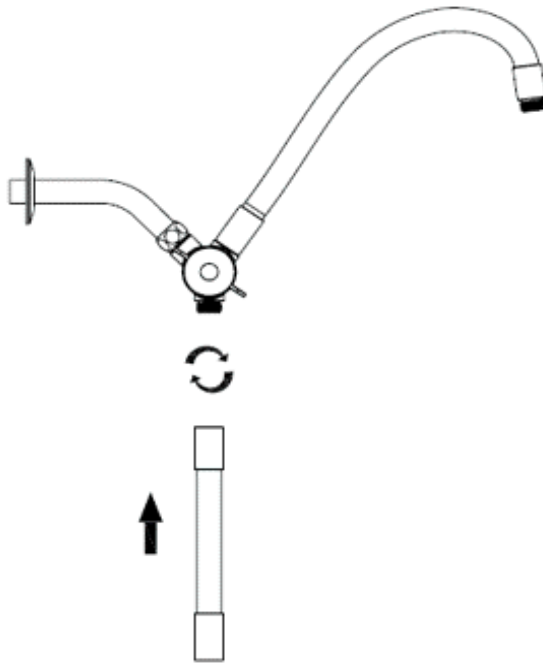

4. Attach the holding bracket onto the bottom end of the down tube.

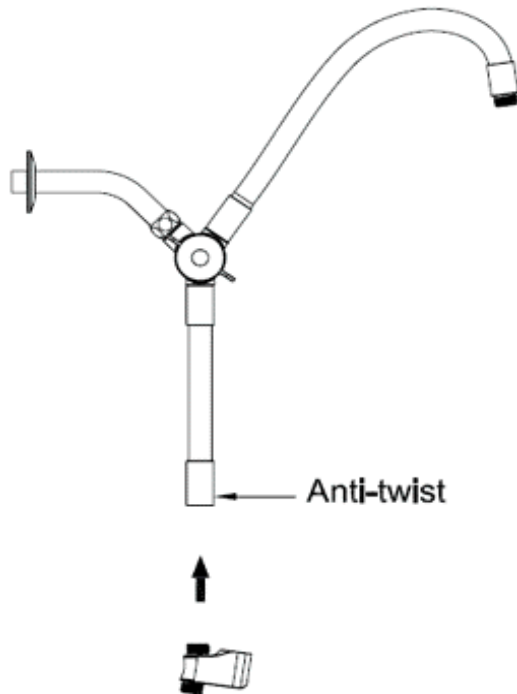

5. Insert the flexible washer into the hex nut end of the shower hose and attach to the bottom of the hand-shower holder.

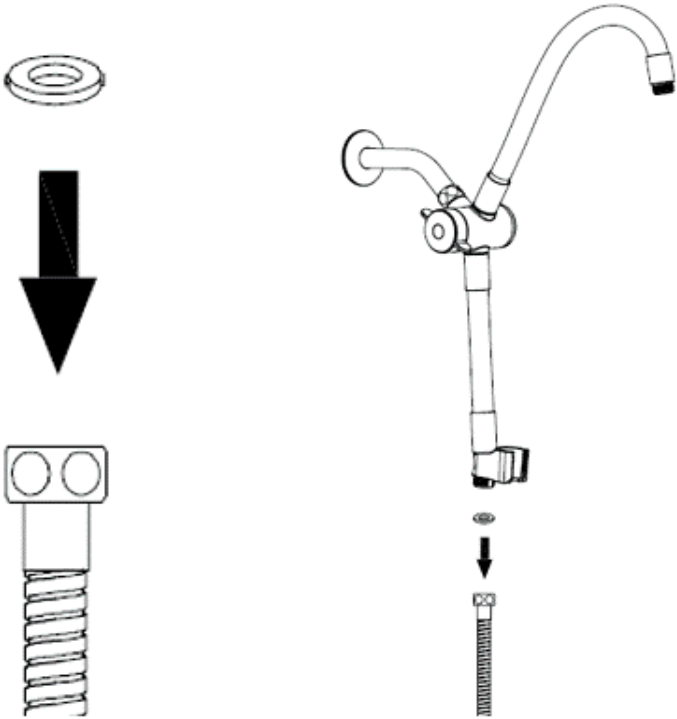

6. Insert second flexible washer into smooth end of shower hose and attach it to the hand-shower.



7. Slide the hand-shower into the holding bracket from the top. DO NOT ATTEMPT TO PUSH THE HAND SHOWER INTO THE HOLDING BRACKET – IT WILL BREAK.

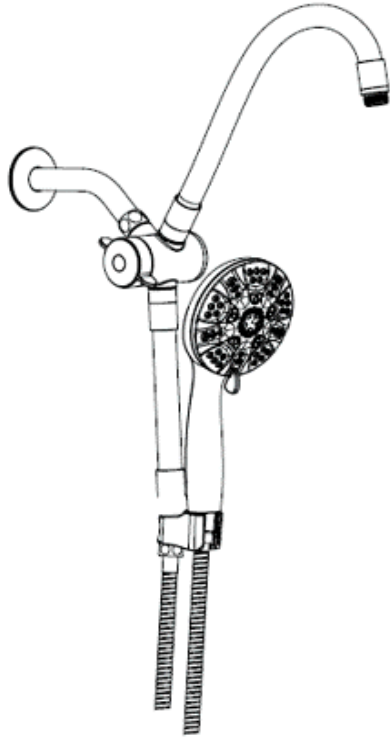

8. Attach the shower head onto the upper tube.



9. Secure shower head by inserting and tightening the included set screw with the provided allen wrench.

